

MARINE DIESEL ENGINES

PLEASURE-CRAFT POWER

2GM20F(V)
13.4kW (18.2hp)

YANMAR

Introducing the SUPER-POWERED version of our popular 2GMF

Ups Power, Stays Trim

We've put more punch into our popular 2GM and kept its ideal proportions in creating the new 2GM20F. Power jumps by 20%, giving an extra surge to carry the 2GM20F into a whole lot wider range of boats. Boat owners will get more from their motor, without getting more motor, because in size and weight it's practically the same, only the flywheel is bigger for greater inertia, easier starting.

Smooth, Clean and Quiet

Comparative tests and actual user reports prove the GM series are more acceptable inboards than equivalent engines. The greater piston bore of the 2GM20F delivers more boost yet still excels in quiet and smooth running from idling to top revs. Emission levels are the lowest in the history of this class of engine, and the 2GM20F exhaust is soot-free.

More Efficient Electrics

The alternator is highly uprated to 55 amps, providing ample current for auxiliary electric power from the battery and a strong source for charging.

Greater Power from the Prop

With the increase in horsepower the builder can equip the boat with a larger propeller or a more dynamic pitch to give extra thrust without extra bed space or redesigning.

Fresh Water Cooling Designed In

With a fresh water cooling system as an integrated part of this engine it becomes more durable and can readily be adapted for an on-board hot water system.

V-Drive Gear

Where fore-aft space is limited this new V-Drive Marine Gear KM3V compactly and neatly solves the problem. It has a drive angle of 15° and a choice of reduction gears—2.36, 2.61, and 3.20.



SPECIFICATIONS

Model		2GM20F	
Configuration		4-s	
Number of cylinders			
Bore × stroke		mm (in.)	
Displacement		ℓ (cu.in.)	
Continuous rating output at crankshaft		kW/rpm (hp/rpm)	
Maximum output at crankshaft		kW/rpm (hp/rpm)	
Combustion system		Sp	
Starting system		Electrical (
Cooling system		F	
Lubrication system			
Reduction and reversing gear	Model	KM2P	
	Type	C	
	Reduction ratio (Ahead/Astern)	2.21/3.06	2.62/3.06
	Propeller speed at continuous rating (Ahead) rpm	1540	1298
Direction of rotation	Crankshaft	Counterclockwise, viewed	
	Propeller shaft		
Dry weight		kg (lbs)	114 (251)

Rating condition: ISO-3046/1 [Note]: hp ≈ 0.7355kW

DIMENSIONS Unit: mm (in.)

2GM20F (× KM2P)

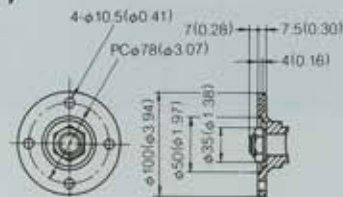

Detail of coupling (A)

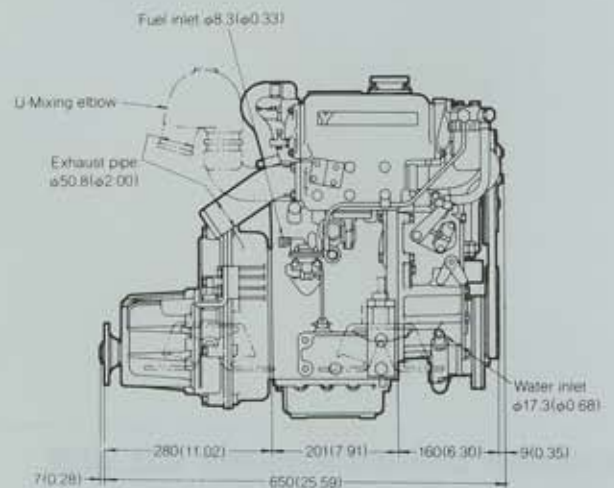
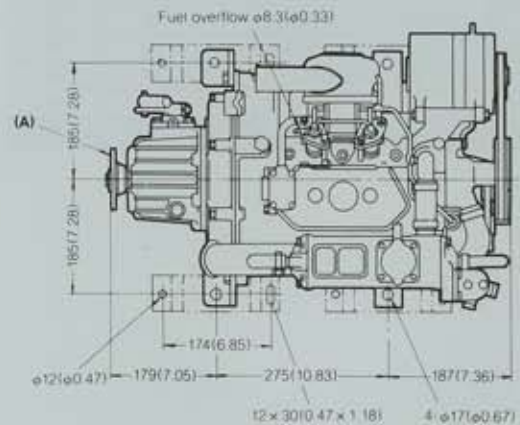
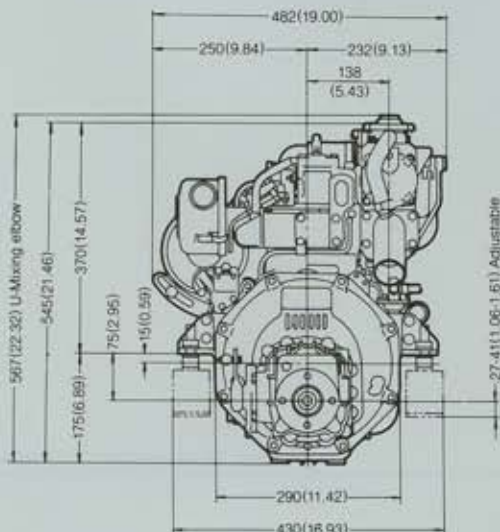

GM20F		2GM20FV		
4-stroke, vertical, water cooled diesel engine				
2				
75 × 72 (2.95 × 2.83)				
0.636 (38.81)				
11.8/3400 (16.0/3400)				
13.4/3600 (18.2/3600)				
Special swirl type pre-combustion chamber				
Electrical (D.C. 12V-1.0kW starting motor, 12V-55A Alternator)				
Fresh water cooling with heat exchanger				
Forced lubrication with trochoid pump				
KM2P		KM3V (V-drive)		
Constant mesh gear with servo-cone clutch				
6.2/3.06	3.22/3.06	2.36/3.16	2.61/3.16	3.20/3.16
1298	1055	1441	1303	1063
Clockwise, viewed from stern		Clockwise, viewed from stern		
Clockwise, viewed from stern		Clockwise, viewed from stern		
14 (251)		125 (278)		

PERFORMANCE CURVES

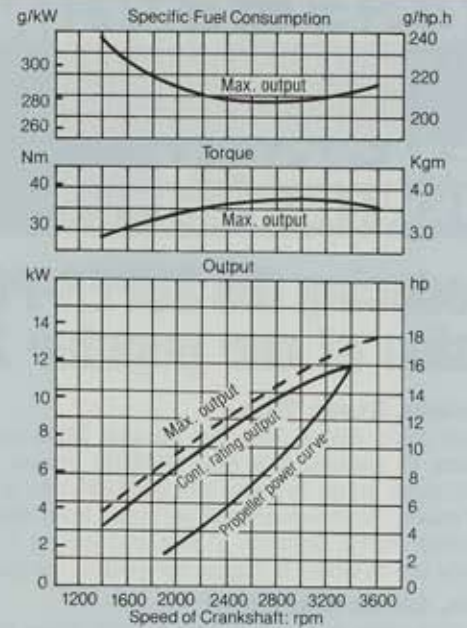

Note:

- Above data are measured at crankshaft and show the average performance as tested at our laboratory.
- Power loss of the marine gears are as follows: KM2P-1.5%, KM3V-2%.

2GM20FV (× KM3V)

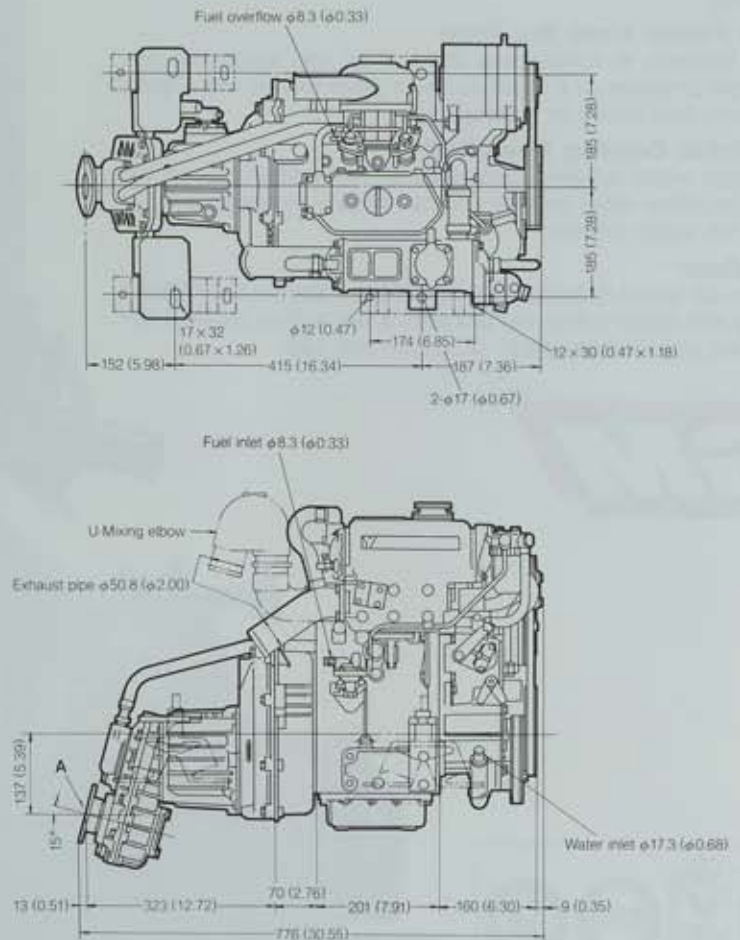
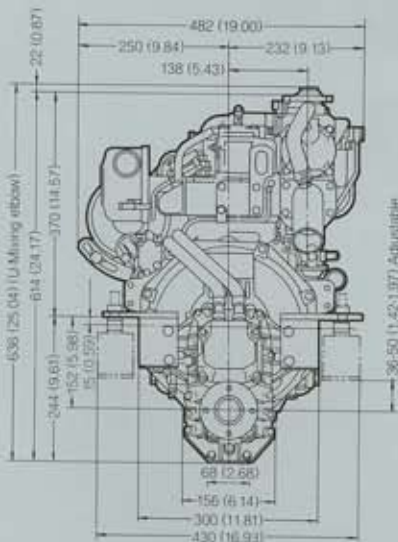
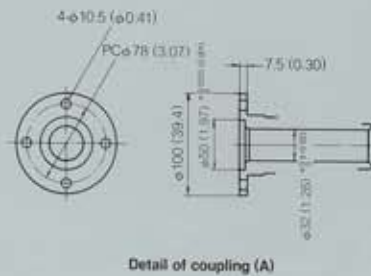

ACCESSORIES

Standard: ○ Option: ▲

Item	Name		Remarks
Installation	Flexible engine mount	○	
	Propeller shaft half coupling (Slit type)	▲	φ20
	Propeller shaft half coupling (Taper type)	▲	φ25 or 28
	Propeller shaft half coupling (Straight rough bore)	▲	φ16
Fuel	Fuel tank with pipe (30//2m)	▲	
Cooling	Exhaust water mixing elbow, L-type	○	
	Exhaust water mixing elbow, U-type	▲	
	Kingston cock	▲	
Lubrication	Lube oil evacuation pump	▲	
Starting and stopping	Engine stop cable (Manual)	▲	3m
Electrical & Instrumentation	Alternator, 12V	▲	35A
	Electric type bilge pump, 12V	▲	
	A-type instrument panel	▲	
	B-type instrument panel	▲	
	Extension wire harness	▲	3m
	Battery switch	▲	
	Two pole wire harness for Eng.	▲	
	Two pole alarm switch ass'y for A & B-type	▲	
Control	Push-pull type remote control cable, 2pcs/unit. (MORSE: 33C)	▲	4m
	Side-mount type single control head. (MORSE: MV)	▲	
	Top-mount type single control head. (MORSE: MT2)	▲	
Others	Spare parts kit	▲	
	Special overhauling tools (for engine)	▲	
	Special overhauling tools (for marine gear)	▲	

INSTRUMENT PANEL

Available: ● Not available: —

		A-type	B-type
1.	Key switch	●	●
2.	Push button switch for starting	●	●
3.	Alarm buzzer	●	●
4.	Alarm lamps	C.W. temp., L.O. pressure	●
		Battery not charging	●
		C.W. high temperature	●
5.	Tachometer	—	●
		L.O. low pressure	●
6.	Tachometer illumination switch	—	●

Unit: mm (in.)

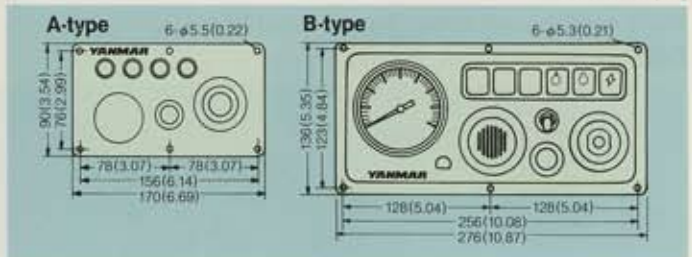

Note: All data subject to alteration without notice.

YANMAR DIESEL ENGINE CO., LTD.



OVERSEAS OPERATIONS DIVISION

1-1, 2-chome, Yaesu, Chuo-ku, Tokyo 104, Japan
 Telex: 0222-4733 Telephone: 03-3275-4933
 Facsimile: 03-3275-4967 Cable: YANMAR TOKYO